

Trusted multifunctional, with versatile end-to-end document capabilities

The imageRUNNER ADVANCE 4500i series is a robust, dependable office multifunctional that will benefit any small working group by improving their day-to-day workflows.

Workflow Efficiency

- Intuitive user interface with a large, colour touchscreen provides users with smartphone-like usability, making navigation a breeze.
- Single-Pass document feeder option provides effortless, rapid scanning with features like multi-sheet feed detection and skip blank originals.
- My ADVANCE enables a unique, personal experience tailored to meet each user's workflow needs. Settings, such as display language, initial log-in screen, and accessibility options, can be synchronised across multiple devices for consistency.
- Canon's MEAP platform provides process optimisation, by integrating with a range of powerful document, capture and output management solutions.
- Scalable support for mobile where users can connect directly to the device with Direct Access Point. Capture, scan or print documents easily with the Canon Print Business app.
- Intelligent Recovery wakes device from sleep mode when user is approaching device via motion sensor technology.
- Wide range of finishing functions such as Staple-on-Demand, ECO-Staple, booklet, folding, double/corner stapling are available as an option for versatile document creation.

Cost Management

- The ability to apply print policies, monitor output, and restrict usage by user helps reduce unnecessary printing, resulting in lower total document cost.
- Tight integration with output management solutions, such as uniFLOW, provides the ability to carry out detailed tracking, reporting, and cost analysis.
- Quality and reliability, combined with remote diagnostics and assistance, can help reduce costs by minimising downtime and time spent by IT resolving issues.
- Consistent user operation combined with remote and centralised fleet management can help simplify IT management of devices and entire fleets.



Security

- Control who has access to the device with user authentication without impacting on user productivity or convenience.
- Prevent unauthorised distribution of sensitive information with an array of standard and optional document security features.
- Ensure information privacy and security across your network with IPsec, port filtering capabilities, and SSL technology.
- Enhance document confidentiality with encrypted secure print, secure print, secure watermark, encrypted PDF and device signature PDF.

Device and Fleet Management Efficiency

- Synchronise personalised user settings across multiple devices through My ADVANCE Sync.
- Canon's device management tools give you a centralised point of control across your entire fleet, upgrade devices remotely, check device and consumables status and capture meter readings.
- Standard PCL and optional Adobe® PostScript® 3™ print driver allows seamless integration with enterprise applications.
- Remote diagnostics allow timely, accurate and effective resolution.
- Intuitive user maintenance videos and status notifications available to help achieve maximum uptime and keep supplies replenished.

Reliability

- Canon's signature reliability and engine technologies contribute to high-quality output to meet the needs of busy departments.
- State-of-the-art imaging technologies and toner allow for consistent images in rich black-and-white tones and 1200-dpi print resolution.
- Maximum paper capacity of 6,335 sheets reduces downtime.

Sustainability

- Canon's innovative Quick Fixing (QF) toner enables high quality fixing at low temperature and pressure, reducing power consumption and optimise productivity.
- Minimise paper wastage by holding jobs at the device with Force Hold Print. Choose to preview your print jobs or even change print settings at the device to achieve the desired results at the first time of printing.
- Incorporates sustainable design, with the use of recycled materials and biobase plastic, and a focus on minimising environmental impact.
- Consumes as little as 0.9W in sleep mode.

Configuration

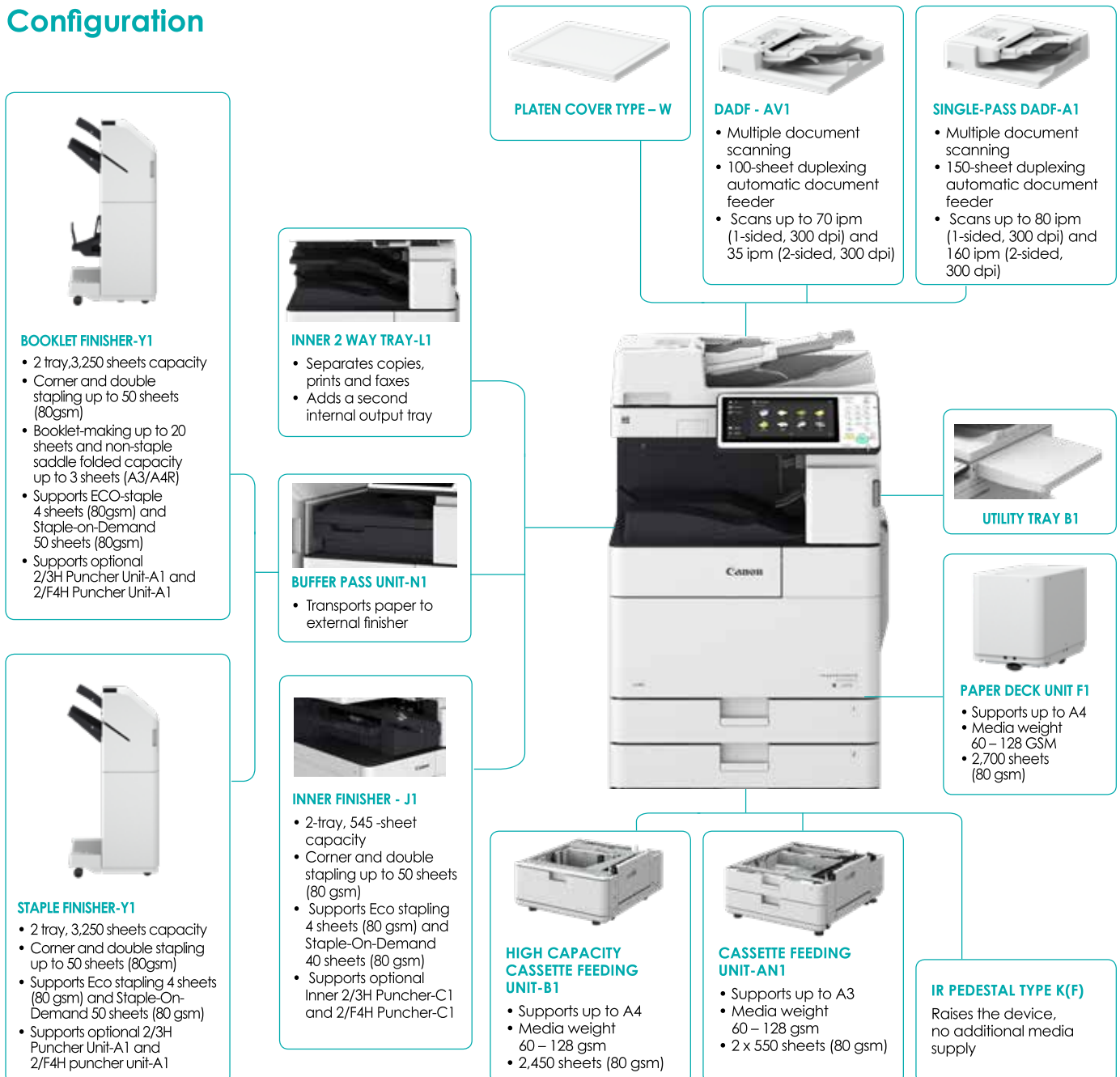

MAIN UNIT

Type

Monochrome Laser Multifunctional

Core Function

Print, Copy, Scan, Send, Store and Optional Fax

Processor

Canon Dual Custom Processor (Shared)

Control Panel

Standard : 10.1 inch TFT LCD WSVGA Colour Touch Panel

Memory

Standard : 3.0GB RAM

Hard Disk Drive

Standard : 250GB

Maximum: 1TB

Mirroring Hard Disk Drive

Optional 250GB, 1TB

Interface Connection

Network Standard: 1000Base-T/100Base-TX/10Base-T,

Wireless LAN (IEEE 802.11 b/g/n)

Optional : NFC, Bluetooth

Others Standard: USB 2.0 x2 (Host), USB 3.0 x1 (Host),

USB 2.0 x1 (Device)

Optional : Serial Interface, Copy Control

Interface

Paper Capacity (80gsm/A4)

Standard : 1,185 Sheets

Maximum: 6,335 Sheets

Paper Sources (80gsm/A4)

Standard : Two 550-sheet Paper Cassettes

85-sheet Multi-purpose tray

Optional : **CASSETTE FEEDING UNIT-A1:**

Two 550-sheet Paper Cassettes

HIGH CAPACITY CASSETTE FEEDING UNIT-B1:

2,450-sheet Paper deck

PAPER DECK UNIT-F1:

2,700-sheet Paper deck

Maximum: 6,335 Sheets

Paper Output Capacity (80gsm/A4)

Standard : 250 Sheets

Maximum: 3,350 Sheets

(with STAPLE FINISHER-Y1/BOOKLET FINISHER-Y1)

Finishing Capabilities

Standard : Collate, Group

With Inner Finisher option: Offset, Collate, Group, Staple,

Hole Punch*, ECO-Staple, Staple-On Demand

With External Finisher option: Offset, Collate, Group, Staple,

Hole Punch*, Saddle Stitch**, ECO-Staple,

Staple-On Demand

*Require inner hole puncher option

**Require Booklet Finish-Y1 option

Supported Media Types

Cassettes (1/2):

Thin paper, Plain paper, Thick paper, Colour paper,
Recycled paper, Pre-punched paper

Multi-Purpose Tray:

Thin paper, Plain paper, Thick paper, Colour paper,
Recycled paper, Pre-punched paper, *Transparency,
Tracing paper, Label, Bond paper, Envelope

Cassette Feeding Unit-A1 (3/4):

Thin paper, Plain paper, Thick paper, Colour paper,
Recycled paper, Pre-punched paper

High Capacity Cassette Feeding Unit-B1:

Thin paper, Plain paper, Thick paper, Colour paper,
Recycled paper, Pre-punched paper

Paper Deck Unit-F1:

Thin paper, Plain paper, Thick paper, Colour paper,
Recycled paper, Pre-punched paper

*Use only A4 transparencies made especially for multi-functional device

Supported Media Sizes

Cassette 1:

Standard size : B4, A4, A4R, B5, B5R, A5R

Custom Size : Min. 139.7 x 182 mm up to 297 x 390 mm

Cassette 2:

Standard size : A3, B4, A4, A4R, B5, B5R, A5R, Foolscap,
India Legal, F4A

Custom Size : Min. 139.7 x 182 mm up to 297 x 431.8 mm

Cassette Feeding Unit-A1 (3/4):

Standard size : A3, B4, A4, A4R, B5, B5R, A5R, Foolscap,
India Legal, F4A

Custom Size : 139.7 x 182 mm up to 297 x 431.8 mm

High Capacity Cassette Feeding Unit-B1: A4

Paper Deck Unit-F1: A4, B5

Multi-Purpose Tray:

Standard size : A3, B4, A4, A4R, B5, B5R, A5R, Foolscap,
India Legal, F4A

Custom Size : 98 x 148 mm up to 297 x 431.8 mm

Supported Media Weights

CASSETTES : 60 to 128 gsm

MULTI-PURPOSE TRAY : 52 to 220 gsm

DUPLEX : 60 to 105 gsm

Warm-up Time

From Power On* : 24 Seconds or Less

*Time between device power-on and when the start key is enabled
(Force Hold print)

From Deep Sleep Mode : 10 Seconds or Less

Quick Startup Mode : 4 seconds or less**

** If <Quick Startup Settings for Main Power> is set to "On", it takes 4 seconds until the key operation on the touch panel display is available after turning on the main power of the machine. Depending on the situations, the machine does not startup quickly.

Dimensions (W x D x H)

With SINGLE PASS DADF-A1: 587 x 740 x 945 mm

With DADF-AV1: 587 x 750 x 926 mm

Installation Space (W x D)

Basic : 889 x 1171.9 mm (with SINGLE PASS

DADF-A1 + Multi-purpose tray open +

Cassette Drawers open)

889 mm x 1181.9 mm (with DADF-AV1 +

Multi-purpose tray open + Cassette

Drawers open)

Fully : 1,811 mm x 1,269.9 mm (with SINGLE PASS

DADF-A1 + PAPER DECK UNIT-F1 +

BOOKLET FINISHER-Y1 + Cassette Drawers

open)

1,811 mm x 1,279.9 mm (with DADF-AV1 +

PAPER DECK UNIT-F1 + BOOKLET

FINISHER-Y1 + Cassette Drawers open)

Weight including the toner bottle

Approx. 86.6kg (with SINGLE PASS DADF-A1)

Approx. 81.3kg (with DADF-AV1)

Print Specifications

Printing Method

Monochrome laser beam printing

Print Speed

iR-ADV 4551i 51 ppm (A4) 25 ppm (A3)

iR-ADV 4545i 45 ppm (A4) 22 ppm (A3)

iR-ADV 4535i 35 ppm (A4) 22 ppm (A3)

iR-ADV 4525i 25 ppm (A4) 15 ppm (A3)

Print Resolution

Up to 1,200 dpi x 1,200 dpi

Page Description Languages

UFR II (Standard), PCL6 (Standard), Adobe PS 3 (Option)

Double Sided Printing

Automatic (Standard)

Direct Print

Direct printing available from USB memory key,

Advanced box, Remote UI and Web Access*

Supported File Types: PDF, TIFF, JPEG, XPS

*Only PDF print from websites is supported.

Fonts

PCL fonts: 93 Roman, 10 Bitmap fonts, 2 OCR fonts,
Andalé Mono WT J/K/S/T* (Japanese, Korean,
Simplified and Traditional Chinese),
Barcode fonts**

*Requires optional PCL INTERNATIONAL FONT SET-A1

**Requires optional BARCODE PRINTING KIT-D1

PS fonts: 136 Roman

Operating System

UFR II: Windows Vista/Server 2008/Windows 7/Server 2008
R2/Server 2012/Windows 8.1/Server 2012 R2/
Windows 10/Server 2016, MAC OS X (10.7 or later)

PCL: Windows Vista/Server 2008/Windows 7/Server 2008
R2/Server 2012/Windows 8.1/Server 2012 R2/
Windows 10/Server 2016

PS: Windows Vista/Server 2008/Windows 7/Server 2008
R2/Server 2012/Windows 8.1/Server 2012 R2/
Windows 10/Server 2016, MAC OS X (10.7 or later)

PPD: MAC OS X (10.3.9 or later), Windows Vista/
Windows 7/Windows8.1/Windows10

Copy Specifications

Copy Speed (BW)

iR-ADV 4551i 51 ppm (A4) 25 ppm (A3)

iR-ADV 4545i 45 ppm (A4) 22 ppm (A3)

iR-ADV 4535i 35 ppm (A4) 22 ppm (A3)

iR-ADV 4525i 25 ppm (A4) 15 ppm (A3)

*First-Copy-Out Time (A4)

* 20 °C to 30 °C Environment

iR-ADV 4551i: Approx. 3.7 seconds or less

iR-ADV 4545i/4535i: Approx. 3.8 seconds or less

iR-ADV 4525i: Approx. 5.2 seconds or less

Copy Resolution

Reading : 600 dpi x 600 dpi

Printing : 1,200 dpi x 1,200 dpi

Multiple Copies

Up to 999 copies

Copy Exposure

Automatic or Manual (9 Levels)

Magnification

25% - 400% (1% Increments)

Preset Reductions

25%, 50%, 61%, 70%, 81%, 86%

Preset Enlargements

115%, 122%, 141%, 200%, 400%

Scan Specifications

Type

Single-pass Duplexing Automatic Document Feeder or
Duplexing Automatic Document Feeder

Document Feeder Paper Capacity

SINGLE PASS (SP) DADF-A1: 150 Sheets (80 gsm)

DADF-AV1: 100 Sheets (80 gsm)

Document Feeder Supported Media Weights

SP DADF-A1

Single-sided scanning: 38 to 157 gsm (BW)

64 to 157 gsm (CL)

Double-sided scanning: 50 to 157 gsm (BW)

64 to 157 gsm (CL)

DADF-A1

Single-sided scanning: 38 to 128 gsm (BW)

64 to 128 gsm (CL)

Double-sided scanning: 50 to 128 gsm (BW)

64 to 128 gsm (CL)

Pull Scan Spec

Color Network ScanGear2. For both Twain and WIA

Supported OS: Windows Vista/7/8.1/10 Windows Server

2008/Server 2008 R2/Server 2012/

Server 2012 R2/ Server 2016

Scan Resolution

100 x 100 dpi, 150 x 150 dpi, 200 x 100 dpi, 200 x 200 dpi,

200 x 400 dpi, 300 x 300 dpi, 400 x 400 dpi, 600 x 600 dpi

Acceptable Originals

Platen : Sheet, Book, 3-Dimensional Objects [Up to 2kg]

Feeder : SP DADF-A1: A3, B4, A4, A4R, B5, B5R, A5, A5R, B6

DADF-AV1: A3, B4, A4, A4R, B5, B5R, A5, A5R, B6

Scan Speed (A4)

SP DADF-A1:

Single-sided Scanning (BW): 80 ipm (300pi)/80 ipm (600 dpi)

Single-sided Scanning (Colour): 80 ipm (300pi)/60 ipm (600 dpi)

Double-sided Scanning (BW): 160 ipm (300pi)/150 ipm (600 dpi)

Double-sided Scanning (Colour): 160 ipm (300pi)/80 ipm (600 dpi)

DADF-AV1:

Single-sided Scanning (BW): 70 ipm (300pi) / 51 ipm (600 dpi)

Single-sided Scanning (Colour): 70 ipm (300pi) / 51 ipm (600 dpi)

Double-sided Scanning (BW): 35 ipm (300pi) / 25.5 ipm (600 dpi)

Double-sided Scanning (Color): 35 ipm (300pi) / 25.5 ipm (600 dpi)

Double sided scanning

2-sided to 2-sided (Automatic)

Send Specifications

Optional/ standard

Standard on all models

Destination

E-mail/Internet FAX (SMTP), SMB, FTP, WebDAV, Mail Box,

Super G3 FAX(Optional), IP Fax(Optional)

Colour Mode

Automatic-Colour Select (Full Colour/Grayscale),

Automatic-Colour Select(Full Colour/Black-and-White),

Full colour, Grayscale, and Black-and-White

Address Book

LDAP (2,000)/Local (1,600)/One-touch (200)

Send Resolution

100 x 100 dpi, 150 x 150 dpi, 200 x 100 dpi, 200 x 200 dpi,

200 x 400 dpi, 300 x 300 dpi, 400 x 400 dpi, 600 x 600 dpi

Communication Protocol

File : FTP, SMB 3.0, WebDAV

E-mail/I-Fax : SMTP, POP3, I-Fax (Simple, Full)

File Format

Standard : TIFF, JPEG, PDF(Compact, Apply policy,
Optimize for Web, PDF A/1-b, Encrypted),

XPS(Compact), PDF/XPS(Digital Signature)

Optional

: PDF(Searchable, Trace&Smooth

XPS(Searchable), Office Open XML

(PowerPoint, Word)

Fax Specifications

Optional/ Standard

Optional on all models

Maximum Number of Connection Lines

4

Modem Speed

Super G3: 33.6 kbps

G3 : 14.4 kbps

Compression Method

MH, MR, MMR, JBIG

Resolution	400 x 400 dpi, 200 x 400 dpi, 200 x 200 dpi, 200 x 100 dpi
Sending/Recording Size	A5 and A5R* to A3 * Sent as A4
FAX Memory	Up to 30,000 pages
Speed Dials	Max. 200
Group Dials/Destinations	Max. 199 dials
Sequential Broadcast	Max. 256 addresses
Memory Backup	Yes

Store Specifications

Mail Box (Number supported)
100 User Inboxes, 1 Memory RX Inbox,
50 Confidential Fax Inboxes
30,000 Maximum Pages Stored

Advanced Box
Communication Protocol: SMB or WebDAV
Supported Client PC: Windows (Windows Vista/7/8/8.1/10)
Concurrent Connections (Max.): SMB: 64, WebDAV: 3
(Active Sessions)

Advanced Box Available Disc Space
Approx. 1.6GB (Standard HDD)
Approx. 480GB (1TB HDD)

Memory Media
Standard: USB Memory

Security Specifications

Authentication
Standard : Picture Login Authentication,
User Authentication, Department ID
Authentication, (Device and Function
Level Login), Access Management System
Optional: My Print Anywhere secure print
(Requires uniFLOW)

Data
Standard: Trusted Platform Module (TPM), Hard Disk
Password Lock, Hard Disk Drive Erase, Hard
Disk Drive Encryption (FIPS140-2 Validated),
Mail Box Password Protection
Optional : Hard Disk Drive Mirroring, Hard Disk Drive
removal, IEEE 2600.2 Common Criteria
Certification.

Network
Standard : IP/Mac Address Filtering, IPSEC, TLS Encrypted
Communication, SNMP V3.0, IEEE 802.1X, IPv6,
SMTP Authentication, POP Authentication
before SMTP

Document
Standard : Secure Print, Encrypted PDF, Encrypted
Secure Print, Device signature, Secure
Watermark
Optional : User signature, Document Scan locking

Environmental Specifications

Operating Environment
Temperature: 10 to 30 °C
Humidity: 20 to 80 % RH (no condensation)

Power Requirements
iR-ADV 4551i: 220-240V(±10 %), 50/60 Hz (±2 Hz) 5.6A
iR-ADV 4545i: 220-240V(±10 %), 50/60 Hz (±2 Hz) 5.2A
iR-ADV 4535i: 220-240V(±10 %), 50/60 Hz (±2 Hz) 5.2A
iR-ADV 4525i: 220-240V(±10 %), 50/60 Hz (±2 Hz) 4.3A

Power Consumption
Maximum: 1.5 kW
Standby: Approx. 37 Wh*
Sleep mode: Approx. 0.9 W**
*Reference Value
**0.9W sleep mode is not available in all circumstances due to certain settings.

Consumables

Toner Yield (Estimated Yield @5% Coverage)
NPG-73 Toner : 42,100 pages

Paper Supply Options

PAPER SUPPLYING UNIT
Cassette Feeding Unit-AN1
Paper Size : A3, B4, A4, A4R, B5R, B5, A5R
Custom size : 139.7 mm x 182.0 mm to
297.0 to 431.8 mm
Paper Weight : 60 to 128 gsm
Paper Capacity : 550 sheets x 2 (80 gsm)
Power Source : From the Main Unit
Dimensions (WxDxH) : 565 x 650 x 248 mm**
Weight : Approx. 23.5 kg
**When attached with the Main Unit

High Capacity Cassette Feeding Unit-B1
Paper Size : A4
Paper Weight : 60 to 128 gsm
Paper Capacity : 2,450 sheets (80 gsm)
Power Source : From the Main Unit
Dimensions (WxDxH) : 565 x 650 x 248 mm**
Weight : Approx. 28 kg
**When attached with the Main Unit

Paper Deck Unit-F1
Paper Size : A4, B5
Paper Weight : 60 to 128 gsm
Paper Capacity : 2,700 sheets (80 gsm)
Power Source : From the Main Unit
Dimensions (WxDxH) : 400 x 630 x 440 mm
Weight : Approx. 31 kg

Software and Printer Management

Remote management tools
eMaintenance: Compatible with eMaintenance
services via embedded RDS
(Enables meter capture, automatic
consumables management,
remote diagnostics and reporting for
service providers to offer efficient, fast
and proactive maintenance)
Content Delivery System: Allows the Remote distribution of
firmware, iR options and MEAP
applications; Remote User Interface
(RUI) Web-based interface to each
device that helps to provide remote
device management and control.
iW Management Console: Server-based software for centralised
management of a fleet of devices
(includes monitoring or consumables,
status monitoring and alerts, distribution
of address books, configuration
settings, firmware and MEAP
applications, meter capture and
reporting, driver and resource
management)

Scanning software
Network ScanGear: TWAIN-compliant scanner driver that
enables computers on a network to
use the pull scan functionality of the
device.

Platform
MEAP (Multifunction Embedded Application Platform):
A powerful JAVA Embedded Platform for Canon devices
which provides tight coupling between a range of
software solutions and the device.

Document Publishing
iW DESKTOP: Powerful print publishing software which
easily combines documents from
different sources and file formats,
applies finishing with preview and
templates to create professional looking
documents. Includes PDF creation,
annotation and compression
capabilities for simple digital workflows
such as proofing and authorization.

Hardware Accessories

For full information on options available for the iR-ADV
4500i series, please refer to the specification tables on
your local Canon web site.

To arrange for a demonstration, simply contact any of our offices below.

SOUTH & SOUTHEAST ASIA REGIONAL HEADQUARTERS

Canon Singapore Pte. Ltd. | 1 Fusionopolis Place #15-01 Galaxis Singapore 138522
Tel: 65-6799 8888 | Fax: 65-799-8882 | www.canon-asia.com | www.canon.com.sg

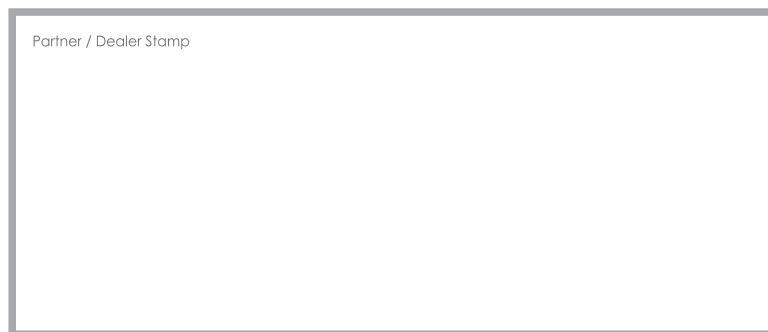

This document is for information purpose only and the contents are subject to change without notice. Product options, name and availability may vary by regions. Nothing in this document should be construed as a warranty. We expressly disclaim any liability or contractual obligations with respect to this document.

Canon, imageRUNNER, imageRUNNER ADVANCE, imageCHIP, RAPID Fusing System, MEAP, eMaintenance, iW, Business can be simple and get Smart get genuine are trademarks of Canon Inc. and/or its affiliates. "MEAP" is a trademark of CANON Inc., referring to an "application platform" for Canon multifunction and single function printers. Other names may be the trademarks of their respective owners. uniFLOW, eCopy and Therefore are independent party software distributed by Canon Singapore Pte Ltd.

Adobe, PostScript, PostScript 3 and the PostScript logo are trademarks of Adobe Systems Incorporated

0211W187 © 2018 Canon Singapore Pte. Ltd.
All rights reserved. Printed in Singapore.